

1.8° 42mm 大力距混合式步进电机

A13

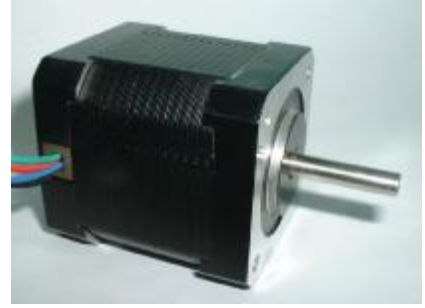

项目	技术参数
步距角	1.8°
步距角精度	±5% (整步, 空载)
电阻精度	±10%
电感精度	±20%
温升	80° C Max.(额定电流,2 相通电)
环境温度	-20° C~+50° C
绝缘电阻	100M Ω Min. ,500VDC
耐压	500VAC 一分钟
径向间隙	0.02Max. (450 g 负载)
轴向间隙	0.08Max. (450 g 负载)
径向最大负载	28N (距法兰面 20mm)
轴向最大负载	10N

I 42mm 大力距混合式步进电机技术参数

型号.		额定电压	电流 /相	电阻 /相	电感 /相	静力矩	引出线	转动惯量	重量	定位力矩	机身长度
Single Shaft	Double Shaft	V	A	Ω	mH	Kg-cm		g-cm ²	kg	g-cm	mm
BL42STH25-0404A	BL42STH25-0404B	9.6	0.4	24	36	1.7	4	20	0.15	75	25
BL42STH33-0956A	BL42STH33-0956B	4	0.95	4.2	2.5	1.6	6	35	0.22	120	34
BL42STH33-0406A	BL42STH33-0406B	9.6	0.4	24	15	1.6	6				
BL42STH33-0316A	BL42STH33-0316B	12	0.31	38.5	21	1.6	6				
BL42STH33-1334A	BL42STH33-1334B	2.8	1.33	2.1	2.5	2.2	4				
BL42STH38-1206A	BL42STH38-1206B	4	1.2	3.3	3.2	2.6	6	54	0.28	150	40
BL42STH38-0806A	BL42STH38-0806B	6	0.8	7.5	6.7	2.6	6				
BL42STH38-0406A	BL42STH38-0406B	12	0.4	30	30	2.6	6				
BL42STH38-1684A	BL42STH38-1684B	2.8	1.68	1.65	3.2	3.6	4				
BL42STH47-1206A	BL42STH47-1206B	4	1.2	3.3	2.8	3.17	6	68	0.35	200	48
BL42STH47-0806A	BL42STH47-0806B	6	0.8	7.5	6.3	3.17	6				
BL42STH47-0406A	BL42STH47-0406B	12	0.4	30	25	3.17	6				
BL42STH47-1684A	BL42STH47-1684B	2.8	1.68	1.65	2.8	4.4	4				
BL42STH60-1206A	BL42STH60-1206B	7.2	1.2	6	7	6.5	6	102	0.5	280	60

尺寸

接线图

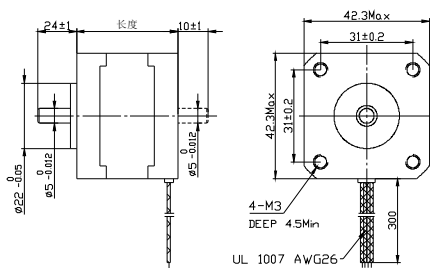

六线

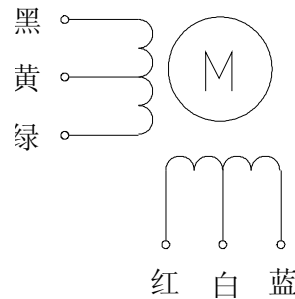

四线

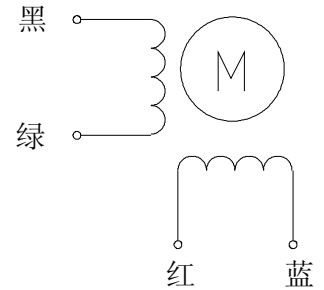

I 距频曲线

A14

BL42STH33-0956A
VM: 24VDC; 1A /相 驱动器: HA335, 半步

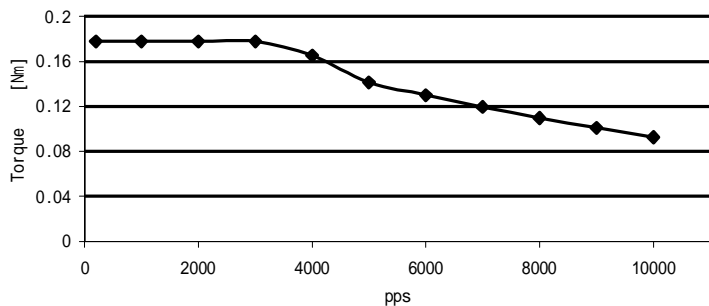

BL42STH33-0406A
VM: 24VDC; 0.5A /相 驱动器: HA335, 半步

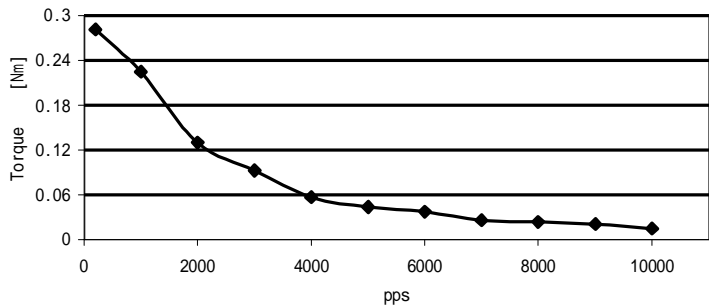

BL42STH33-0316A
VM: 24VDC; 0.3A /相 驱动器: M415B, half step

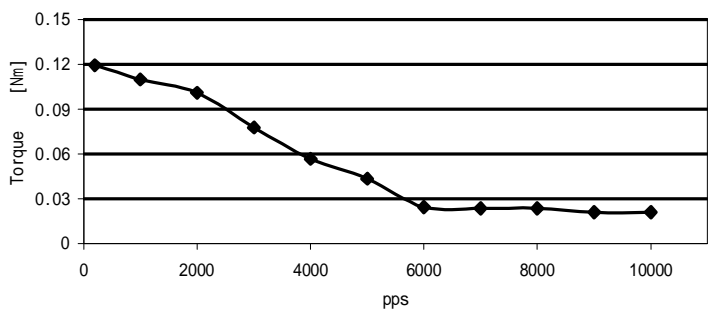

BL42STH33-1334A
VM: 24VDC; 1.27A /相 驱动器: HA335, 半步

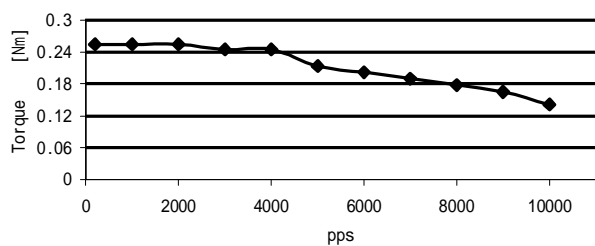

BL42STH38-1206A
VM: 24VDC; 1.2A /相 驱动器: HA335, 半步

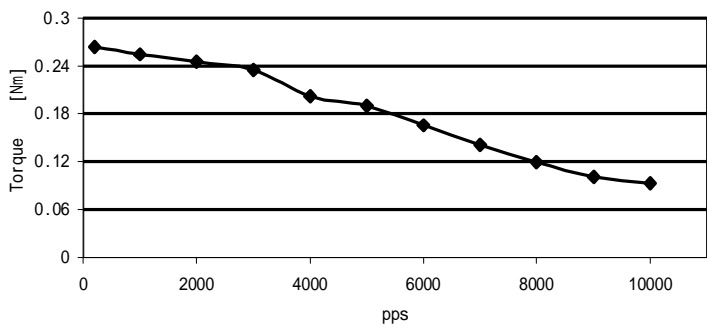

BL42STH38-0806A
VM: 24VDC; 0.8A /相 驱动器: M325, 半步

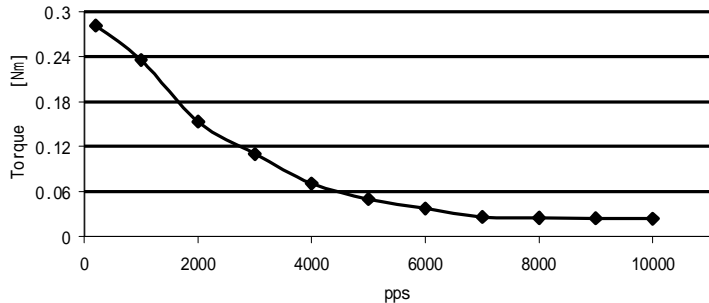

BL42STH38-0406A
VM: 24VDC; 0.5A /相 驱动器: HA335, 半步

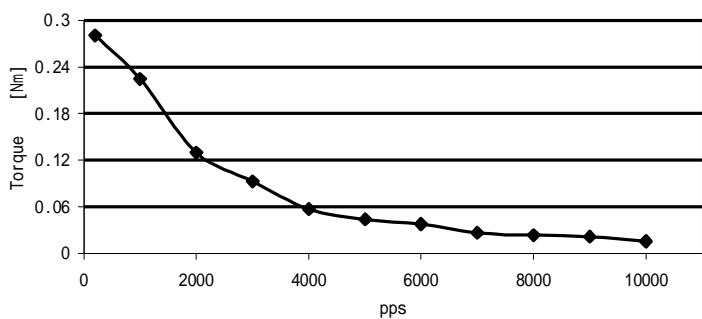

BL42STH38-1684A
VM: 24VDC; 1.77A /相 驱动器: HA335, 半步

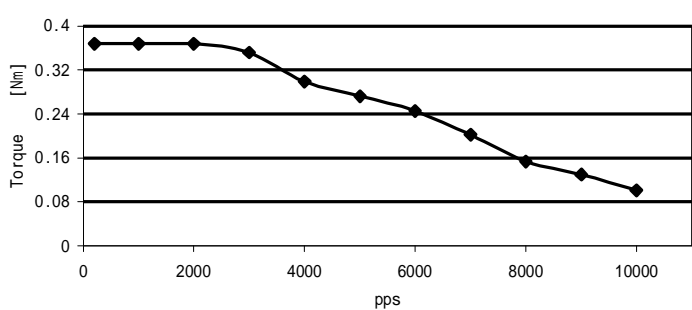

BL42STH47-1206A

VM: 24VDC; 1.2A /相 驱动器: HA335,半步

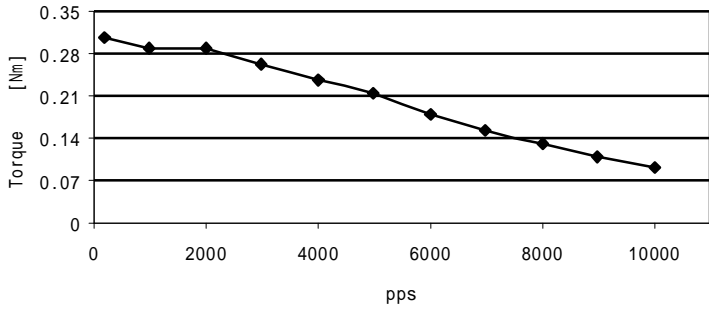

BL42STH47-0806A

VM: 24VDC; 0.8A /相 驱动器: M325,半步

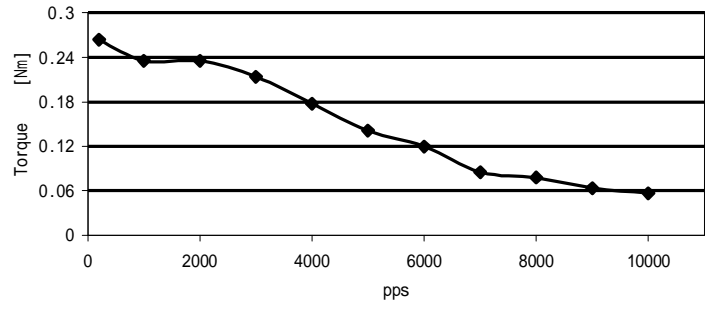

BL42STH47-0406A

VM: 24VDC; 0.44A /Phase () Driver: M415B, half step

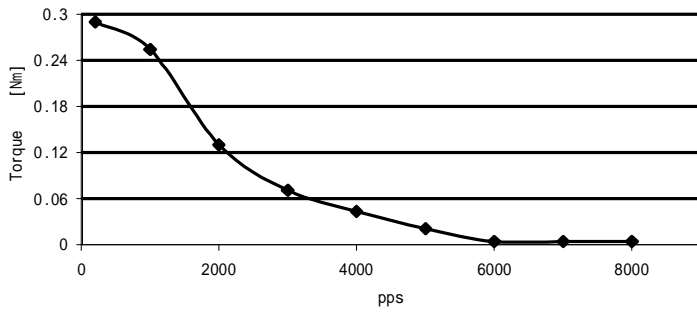

BL42STH47-1684A

VM: 24VDC; 1.77A /Phase () Driver: HA335, half step

